

RMNN4048
 TEMPLE TRANSDUCER
 HEADSET WITH IN-LINE
 PTT.

Technical Specification

Mechanical and Environmental:

Dimensions	Refer to drawing
Approximate weight	120 grams
Operating temperature range	-30°C to + 65 °C
Storage temperature range	-40°C to + 85 °C
Withstanding ESD	15KV max.
Cable pull on connector	min 5Kgf
Cable bending on plug	min 10K cycles
PTT operation	min 100K cycles
Corrosion resistance (exposed metal)	MIL810E
Rain	EN60529, IEC529-IP54



RMN4048

Electrical (Microphone):

Type	Electret, Omni-directional,
Impedance @1KHz	2.2k ohm ± 30% at 1KHz.
Sensitivity	-49dBV±4dB at 1KHz.
Frequency response	300Hz to 7KHz.
Operating voltage	Std voltage 4.5V, max 10V

Electrical (Temple transducer):

Type	Magnetic
Impedance @ 1KHz	36 ohm ±30%
Sensitivity	102dB ±4.5dB at 1KHz 1mW
Distortion @ 1KHz	below 5%
Frequency response	300Hz to 3KHz
Power handling	1W max.
Free from rub and buzz	below 3.8Vrms

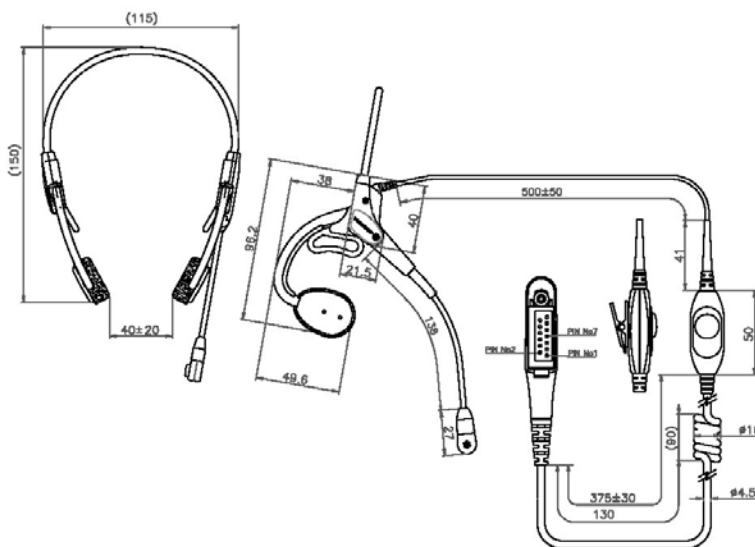

モトローラ無線機
 プレミアディーラー



株式会社トワ

本 社

〒583-0991 大阪府南河内郡太子町春日98-362
 tel 0721-98-1317 fax 0721-98-1373 mail@towa-inc.net

日本橋ショールーム

〒556-0005 大阪市浪速区日本橋4-17-9
 tel 06-6632-5115 fax 06-6632-5110

<http://www.towa-inc.net/>